



**SAVAGE
BROS. CO.**
S I N C E 1 8 5 5

1125 Lunt Avenue
Elk Grove Village, IL 60007-5023 USA



Phone: 847-981-3000
USA Fax: 800-2-SAVAGE
World Fax: +847-981-3010

E-mail: info@savagebros.com
Web: www.savagebros.com

A 21st Century Company . . . with 19th Century Craftsmanship

ElectroStove-20 Candy Stove

Simple to operate and incredibly efficient

Just plug it in, set the variable heat control, and turn out a perfect batch, time after time. All of our electric stoves feature:

- Unique coiled heating system embedded in an insulation mantle shaped to fit the contour of the kettle.
- A focused heating design to move 90% of the heat to the kettle.
- Stainless steel construction
- Special ventilation is not required
- Will not heat up your kitchen
- Two sizes to choose from



Heating Element with Kettle Ring



Shown with Stove mounted Digital Temperature Control Option.
Best kettle size: 20" dia x 11" deep. (above kettle is over-sized)



ElectroStove-20

ETL Certified to UL & NSF Standards

		Model #0100	Model #0101	Model #0105	Model #0106
Electric:	Voltage	220-240 Volts	208 Volts	220-240 Volts	208 Volts
	Phase	3-Phase	3-Phase	1-Phase	1-Phase
	Amperage	20	20	33	34
	Maximum Output	7.2 KW	6.9 KW	7.2 KW	6.9 KW
The Following items apply to all 4 models shown above:					
	Batch Temperature Range	180 – 350 degrees Fahrenheit			
Dimensions:	Height	26 in / 66 cm			
	Outer Diameter	23 in / 58 cm			
Kettle Size:	Best	20" x 11" in (11 gal) / 500 x 290 mm (41.8 L)			
	Maximum	20" x 16" / 500 x 400 mm			
	Shipping Weight	165 lbs / 75 kg.			

3-Phase Plug

Single-Phase Plug

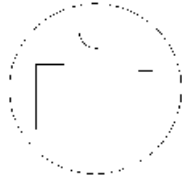

Optional Temperature Control With Probe

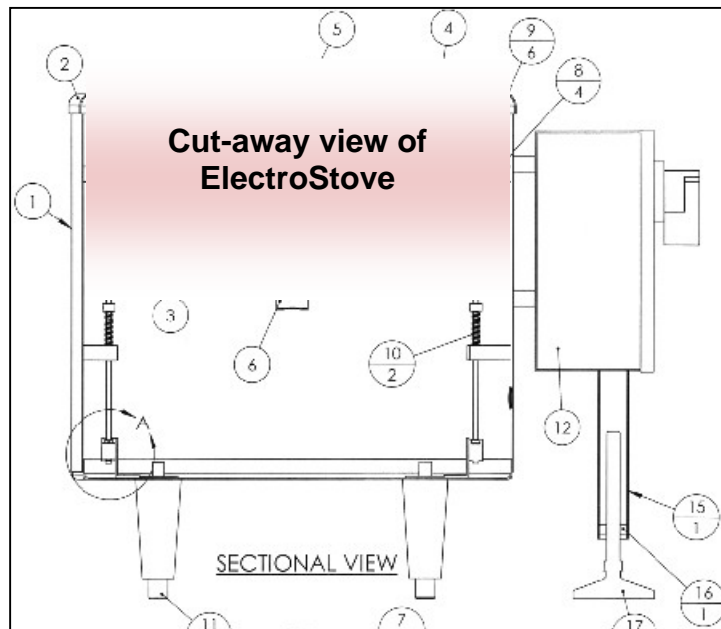

- 1) Stainless Steel outer shell 4) Heating Element
5) ElectroStove Dish 12) Control Box 17) Leveling foot

Would you like an electric cooker, but this model is not quite the right size?

Ask to see our Table-Top Cooker, or full featured S-92 Electric FireMixer.



**SAVAGE
BROS. CO.**
S I N C E 1 8 5 5

1125 Lunt Avenue
Elk Grove Village, IL 60007-5023 USA



Phone: 847-981-3000
USA Fax: 800-2-SAVAGE
World Fax: +847-981-3010

E-mail: info@savagebros.com
Web: www.savagebros.com